

M22010

ESPIGA LISA MÉTRICA RECTA SERIE LIGERA - DIN 2353 / ISO 8434-1

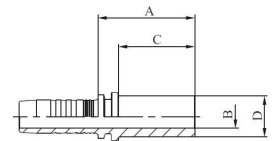

REF.	DIÁMETROS DE MANGUERA			DIMENSIONES			
	DN	Pulgadas	Tamaño	D	B	A	C
M22010-03-04	5	3/16"	- 03	4	2,0	29,6	22,0
M22010-03-06	5	3/16"	- 03	6	3,0	28,6	22,0
M22010-04-06	6	1/4"	- 04	6	3,0	29,5	22,0
M22010-05-08	8	5/16"	- 05	8	5,5	30,0	22,0
M22010-05-10	8	5/16"	- 05	10	7,0	30,5	23,0
M22010-06-10	10	3/8"	- 06	10	7,0	30,6	23,0
M22010-06-12	10	3/8"	- 06	12	8,0	30,6	23,0
M22010-06-15	10	3/8"	- 06	15	10,5	32,6	25,0
M22010-08-12	12	1/2"	- 08	12	8,0	30,9	23,0
M22010-08-15	12	1/2"	- 08	15	10,5	32,9	25,0
M22010-08-18	12	1/2"	- 08	18	12,5	33,9	26,0
M22010-10-18	16	5/8"	- 10	18	12,5	34,2	26,0
M22010-10-22	16	5/8"	- 10	22	15,0	36,2	28,0
M22010-12-18	19	3/4"	- 12	18	15,0	36,2	26,0
M22010-12-22	19	3/4"	- 12	22	15,0	38,0	28,0
M22010-16-28	25	1"	- 16	28	20,5	41,3	30,0
M22010-20-35	31	1.1/4"	- 20	35	26,0	48,5	36,0
M22010-24-42	38	1.1/2"	- 24	42	32,0	52,6	40,0

M22110

ESPIGA LISA MÉTRICA RECTA SERIE PESADA - DIN 2353 / ISO 8434-1

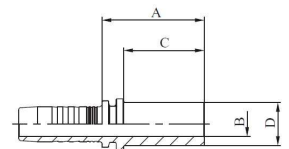

REF.	DIÁMETROS DE MANGUERA			DIMENSIONES			
	DN	Pulgadas	Tamaño	D	B	A	C
M22110-03-08	5	3/16"	- 03	8	3,0	30,6	24,0
M22110-03-10	5	3/16"	- 03	10	3,0	29,5	22,0
M22110-04-08	6	1/4"	- 04	8	4,0	31,5	24,0
M22110-04-10	6	1/4"	- 04	10	4,0	33,5	26,0
M22110-04-12	6	1/4"	- 04	12	7,0	33,5	26,0
M22110-05-12	8	5/16"	- 05	12	7,0	33,5	26,0
M22110-06-14	10	3/8"	- 06	14	8,0	36,6	29,0
M22110-08-14	12	1/2"	- 08	14	9,3	36,9	29,0
M22110-08-16	12	1/2"	- 08	16	10,5	37,9	30,0
M22110-10-20	16	5/8"	- 10	20	12,5	44,2	36,0
M22110-12-20	19	3/4"	- 12	20	15,0	46,0	36,0
M22110-12-25	19	3/4"	- 12	25	15,0	50,0	40,0
M22110-16-25	25	1"	- 16	25	15,0	51,3	40,0
M22110-16-30	25	1"	- 16	30	20,5	55,3	44,0
M22110-16-38	25	1"	- 16	38	26,0	61,3	50,0
M22110-20-30	31	1.1/4"	- 20	30	20,5	56,5	44,0
M22110-20-38	31	1.1/4"	- 20	38	26,0	62,5	50,0
M22110-24-38	38	1.1/2"	- 24	38	26,0	62,6	50,0